

## Ordering Information

Style	Lamps	Length	Type	Wattage	Voltage	Finish
SF	2					
	2 = 2-Lamp T5	4 = 4 Foot 8 = 8 Foot	J = Joiner	28 = 28 watt 54 = 54 watt	1 = 120v 2 = 277v	WH = White Enamel AL = Aluminum Enamel

Complete ordering instructions below.

## Features

- Housing:** Extruded aluminum. Die-cast end plate mechanically attached with no exposed fasteners.
- Lamping:** Two T5 (28 or 54 watt as specified) fluorescent lamps per 4-foot section. Provided by others.
- Shielding:** Sandblasted 1/4" (0.64cm) thick acrylic.

## Electrical

Specify 120 volt or 277 volt. Three conductor, 18 gauge wire. Color-coded quick connectors allow ease of connection for joiner modules. For special circuiting, consult factory. Ballast is class "P" electronic, class "A" sound rating, less than 10% THD, thermally protected, end of lamp life cutoff. Factory installed ballast disconnect allows the ballast to be disconnected from and reconnected to incoming power under load without turning the entire circuit off.

## Mountings

Cable suspension - 4-1/2" (11.43cm) diameter canopy finished white enamel, 1/16" (0.16cm) diameter stainless steel aircraft cable adjustable up to 36" (91.44cm). Griplock® with cable adjustment. Draw tight connector create hairline seam between joiner modules.

## Finish

Powder coated baked white or aluminum enamel.  
Custom colors available, consult factory.

## Options and Accessories

L, T, X inline joiner blocks and emergency battery pack available.

## Labels Included

UL, cUL, and IBEW

Griplock® is a registered trademark of Reutlinger GripLock Systems.

## Ordering Instructions

### Individual Fixtures:

- Order one JOINER MODULE.
- Order one POWER FEED END SET.
- Order one CABLE ASSEMBLY.

### Continuous Rows:

- Determine run length.
- Order the appropriate number of JOINER MODULES to complete the run.
- Order one POWER FEED END SET per run.
- Order one CABLE ASSEMBLY per JOINER MODULE.
- For patterns that exceed amperage limits, order the appropriate number of CABLE/CORD FEEDS.

### Square/Rectangle Patterns:

- Order appropriate number of JOINER MODULES to complete the pattern size.
- Order number and type of JOINER BLOCKS required.
- Order one CABLE/CORD ASSEMBLY or POWER FEED END SET to power the pattern.
- For patterns that exceed amperage limits, order the appropriate number of CABLE/CORD FEEDS.

## Job Information

## Type:

**Job Name:**

**Cat. No.:**

**Lamp(s):**

**Notes:**

## Performance

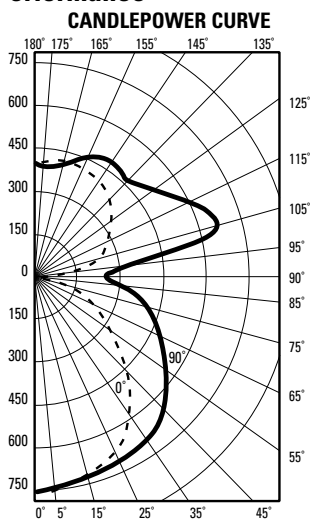

**REPORT NO:** LRL 299-1H  
**CAT NO:** SF24I281WH  
**LAMPS:** 2 F28T5  
**LUMENS:** 2900  
**EFFICIENCY:** 89.5%

ZONE DEG.	CANDLEPOWER				
	0	22	45	67	90
180	412	412	412	412	412
175	415	404	392	382	382
165	415	389	404	424	419
155	408	398	428	462	472
145	383	394	447	493	503
135	343	375	435	467	474
125	301	347	401	499	520
115	217	278	426	562	616
105	138	239	464	621	657
95	95	34	182	235	299
90	90	13	77	162	238
85	85	33	99	191	276
75	75	150	194	292	398
65	65	244	280	372	470
55	55	364	394	472	582
45	45	465	495	544	630
35	35	582	601	632	691
25	25	674	681	690	728
15	15	725	729	725	749
5	5	746	747	740	748
0	0	747	747	747	747

		COEFFICIENTS OF UTILIZATION								
		% EFFECTIVE CEILING CAVITY REFLECTANCE								
ROOM CAVITY RATIO		80			70			50		
		WALL REFLECTANCE								
		70	50	30	70	50	30	50	30	10
0	96	96	96	89	89	89	76	76	76	76
1	87	82	78	80	76	73	65	62	60	60
2	79	72	66	73	66	61	56	52	49	49
3	72	63	56	66	58	52	50	45	41	41
4	66	55	48	60	51	45	44	39	35	35
5	60	49	42	55	46	39	39	34	30	30
6	55	44	37	51	41	34	35	30	26	26
7	51	40	32	47	37	30	32	26	23	23
8	47	36	28	43	33	27	29	23	20	20
9	44	32	25	40	30	24	26	21	17	17
10	40	29	22	37	27	21	23	18	15	15

DISTRIBUTION			
Zone	Lumens	% Lamp	% Luminaire
0-90	2749	47.4	53.0
90-180	2440	42.1	47.0
0-180	5189	89.5	100.0

Calculations are for 28 watt T5 lamps, for 54 watt T5 lamps multiply by 1.7

## Quick Calculator

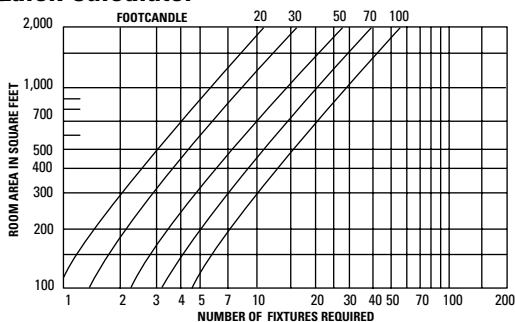

1. Find room area on vertical axis.
2. Move across chart to footcandle curve.
3. Move down to horizontal axis and read number of fixtures required.

## Fixture Lengths & Mounting Locations

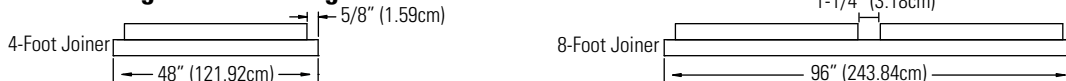

## Sample Run

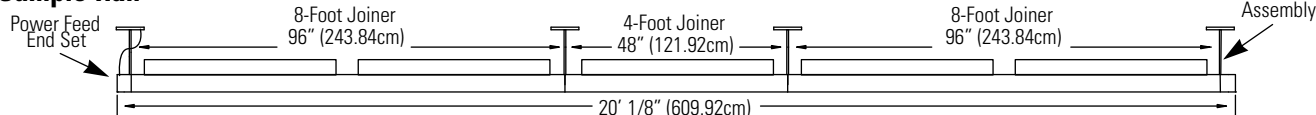

## Mounting & Joiner Block Accessories

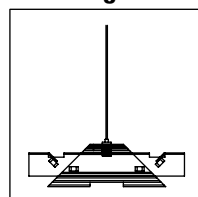

**Cable Assembly**  
SC36

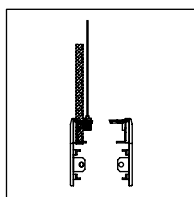

**Power Feed End Set**  
SE36WH (white)  
SE36AL (aluminum)

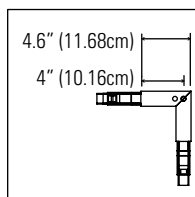

**"L" Block with Suspension**  
SL36WH (white)  
SL36AL (aluminum)

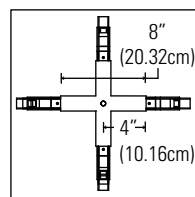

**"X" Block with Suspension**  
SX36WH (white)  
SX36AL (aluminum)

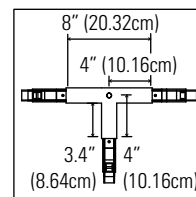

**"T" Block with Suspension**  
ST36WH (white)  
ST36AL (aluminum)

Inline block available (SI36WH or SI36AL).

## Job Information Type: