

# ALTER ELEGANCE QVW8SGLOS218 OR 2FT

SURFACE SCONCE, DIRECT/INDIRECT FLUORESCENT, 2 LAMP, TT5 BI-TUBE, 4" DEEP, GLASS LAMP SHIELD

## Features

- Efficiency 60.9%.
- Uses mounting surface as part of optical system.
- Available in 12" and 24" options
- Installs vertically or horizontally on wall / ceiling
- Providing balance between reflected and direct light.
- 0 deg lamp cutoff.
- One piece body for easy installation.
- Lamp shield constructed of decorative frosted rigidglass and natural satin-finished metal



## Mounting Methods / Features

Swing down optical system for easy relamping and maintenance

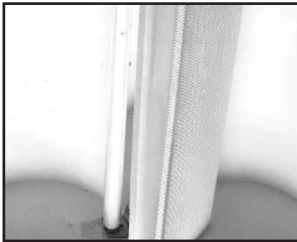

Install vertically or horizontally on walls



Complements its recessed Alter Elegance counterpart



## Dimensions

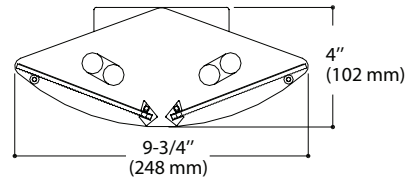
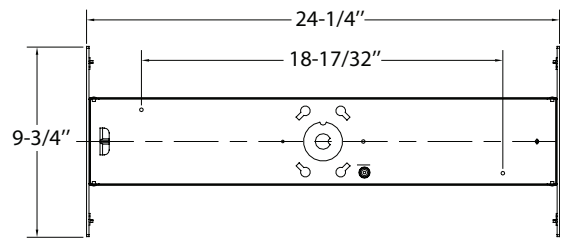
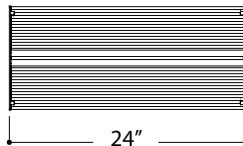
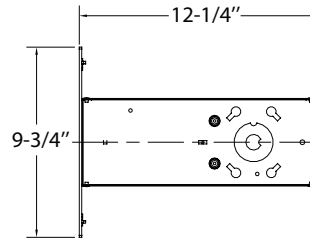
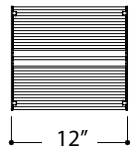

FIXTURE TYPE	VOLTS
JOB INFORMATION: _____	

# ALTER ELEGANCE QVW8SGLOS218 OR 2FT

SURFACE SCONCE, DIRECT/INDIRECT FLUORESCENT, 2 LAMP,  
TT5 BI-TUBE, 4" DEEP, GLASS LAMP SHIELD

## Photometry

Model No. : QVW8SGLOS32FT120SB

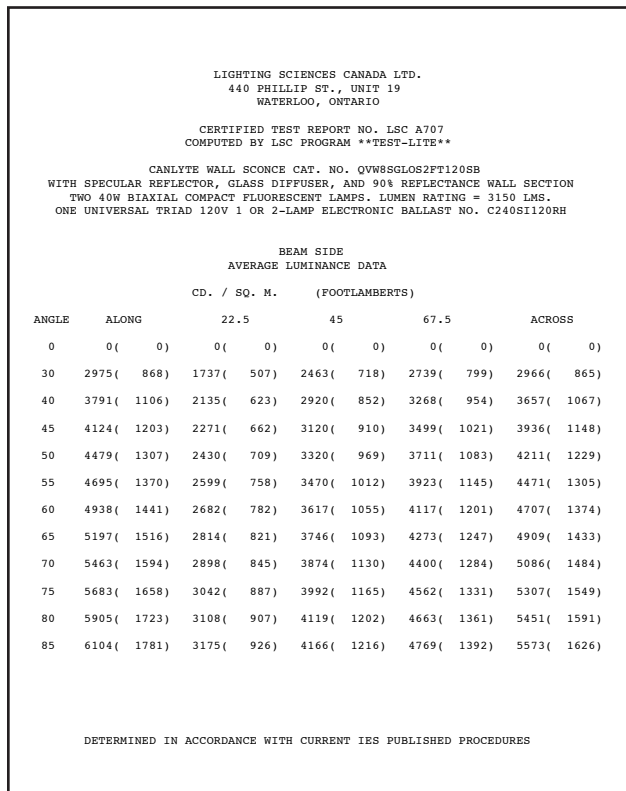
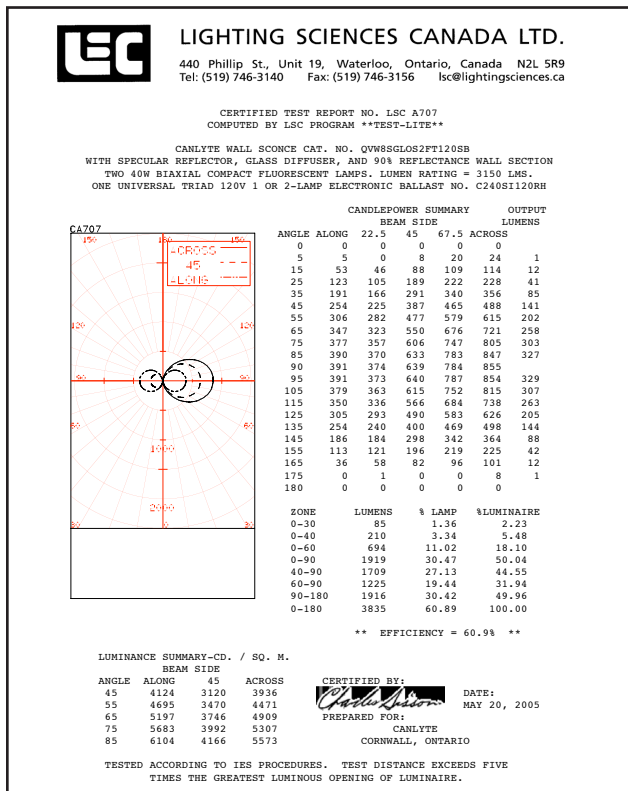

## Ordering Information Explanation of Catalogue Number Example: QVW8SPFOS2FT

<b>QVW</b>	<b>8</b>	<b>S</b>	<b>GL</b>		<b>2</b>	<b>FT</b>			
<b>QUALITY VISUAL STATIC</b>	<b>FIXTURE WIDTH</b>	<b>WALL/SURFACE</b>	<b>LAMP SHIELD</b>	<b>LAMP SHIELD DETAILS</b>	<b>LAMP QUANTITY</b>	<b>LAMP/FIXTURE LENGTH (nominal 24")</b>	<b>VOLTAGE 120, 277, 347 UNV</b>	<b>BALLAST TYPE</b>	<b>OPTIONS</b>
Wall/Surface direct-indirect soft light optical system	9'		GL=Glass	OS=One slot (no acrylic)		FT=TT5 bi-tube 18=18W TT5 (nominal 12")		BA=18W Electronic TT5 RS* BD=55W Electronic TT5 RS* BE=50W Electronic TT5 RS BR=40W Electronic TT5 RS BX=40W Magnetic TT5 RS PB=40W TT5 PowerSpec* PC=50/55W TT5 PowerSpec Dimming* SB=40W Generic Electronic TT5 IS SO=Electronic T8 Instant Start	Add appropriate suffix to catalogue no.

\* Not available in 347V.  
For other ballast options, consult ballast specification sheet (folio BA-1-02)

## SPECIFICATIONS

**MATERIALS:** One piece chassis constructed from die formed 20 gauge cold rolled steel. Reflectors - 95% reflectance baked white acrylic matte paint finish. Soft white acrylic film on inside of lamp shield conceals lamp image.

**FINISH:** Chassis exterior - phosphate undercoating, baked white acrylic matte high reflectance paint finish.

**ELECTRICAL:** Rapid start HPF, thermally protected class "P" ballast (Bi-tube type). If K.O.s are within 3" of ballast use wire suitable for at least 90C.

**LABELS:** Listed by CSA, UL

## Job Information Type:

**Lightolier** a Genlyte Thomas Company  
Technical Information: (978) 657-7600 - (978) 658-0595  
631 Airport Road, Fall River, MA 02720 - (508) 679-8131  
C.F.I. Division of Canlyte, Inc.  
525 Education Road, Cornwall, Ontario, Canada K6H 6C7 - (613) 938-6221  
We reserve the right to change details of design, materials and finish.  
© 2005 Genlyte Thomas Group LLC (Lightolier Division)  
A0902 **Section 5 / Folio L70-40**

**LIGHTOLIER**