

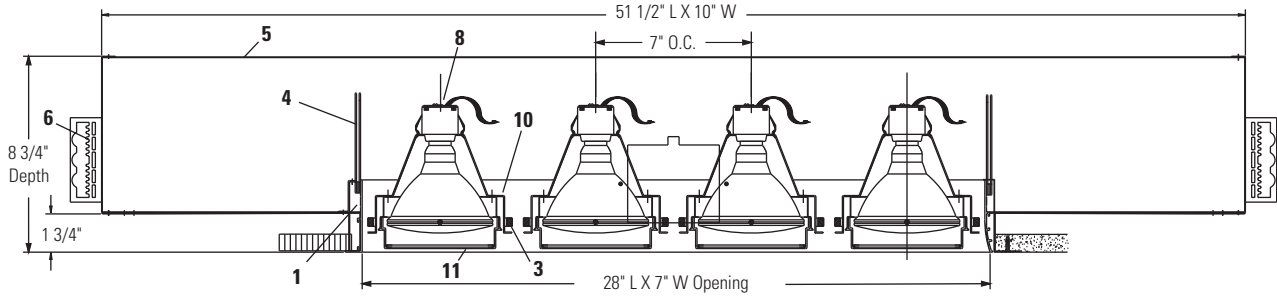

Calculite[®] ProSpec[®] Linear Downlight PB4P3810

Page 1 of 2

4 Light PAR38 Series B

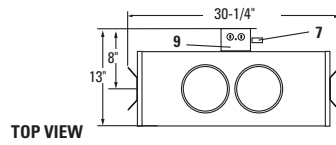

PB4P3810BL = (Flanged) Black/White
PB4P3810WL = (Flanged) White

PB4P3810BTL = (Trimless) Black
PB4P3810WTL = (Trimless) White

Ceiling Cutoff: 29 1/16" L X 8 3/16" W

Ordering Information: PAR38 Series B

Cat. No.	Lamp	Ceiling Trim	Aperture Finish
PB4P3810BL	(4) 100W PAR38	Overlap	Black with White Flange
PB4P3810WL	(4) 100W PAR38	Overlap	White with White Flange
PB4P3810BTL	(4) 100W PAR38	Trimless	Black
PB4P3810WTL	(4) 100W PAR38	Trimless	White

Features

- Aperture Frame:** Provides clean support for lamp holders and overlapping flange or trimless installation. Extruded aluminum. Rigidly welded together on all corners.
- Media Cartridge:** Allows convenient loading and removal of up to one accessory. Easily installed and removed for lamping with a simple twisting motion. Constructed of die-formed aluminum.
- Adjustable Ring:** Allows 360° horizontal and 35°, max. 45° (on length); 40° (on width) vertical adjustment.
- Tortionite Spring:** For easy installation of aperture frame.
- Housing:** Die-formed 22 ga. steel. Finish: Black
- Mounting Brackets:** Adjustable vertically from inside or outside of housing.
- Thermal Protector:** Meets NEC and UL requirements.
- Lampholder:** Porcelain medium based; nickel plated screw shell. Prewired with #18 SF-1 leads to junction box.
- Junction Box:** 14 ga. steel, 4" x 3-1/2" x 2" box. Allows inspection from below.
- Lamp and Accessory Support:** .032" steel, flared for easy entry of Media Cartridge.
- Lens Retaining Ring:** .093" spring steel rod. Holds accessories in place.

Electrical

UL listed for through branch circuit wiring with maximum of (8) no. 12 AWG, 90°C.

Finish

All painted finishes are powder coated baked enamel.

Options and Accessories

Accessories: 4 3/4" dia. series, filters, lenses, screens, and louvers. (1) max.

Label

UL/cUL (Suitable for Damp Location), I.B.E.W.

Job Information	Type:
Job Name:	
Cat. No.:	
Lamp(s):	
Notes:	

Lightolier a Genlyte Thomas Company www.lightolier.com
 631 Airport Road, Fall River, MA 02720 • (508) 679-8131 • Fax (508) 674-4710
 We reserve the right to change details of design, materials and finish.
 © 2011 Genlyte Thomas Group LLC (Lightolier Division) • B0711

LIGHTOLIER[®]



Lighting Performance Data

		Narrow																		
		45W PAR38 NSP (T-H)	45W PAR38 SP (T-H)	75W PAR38 SP	90W PAR38 NSP (T-H)	90W PAR38 SP (T-H)														
DISTANCE																				
FOTCANDLES (On Beam Center At 6')		236	131	144	528	333														
BAM SPREAD (To 50% Max. CP)		6°	14°	12°	7°	12°														
MAX. CANDLEPOWER (Candelas)		8,500	4,700	5,200	19,000	12,000														
RATED LIFE (Hours)		2,000	2,000	2,000	2,000	2,000														
90° AIMING ANGLE Illumination on horizontal Plane 	D	FC	L	W	D	FC	L	W	D	FC	L	W	D	FC	L	W	D	FC	L	W
	7'	173	0.7'	0.7'	6'	131	1.5'	1.5'	6'	144	1.3'	1.3'	10'	190	1.2'	1.2'	8'	188	1.7'	1.7'
	10'	85	1.0'	1.0'	8'	73	2.0'	2.0'	8'	81	1.7'	1.7'	15'	84	1.8'	1.8'	12'	83	2.5'	2.5'
	13'	50	1.4'	1.4'	10'	47	2.5'	2.5'	10'	52	2.1'	2.1'	20'	47	2.4'	2.4'	16'	47	3.4'	3.4'
60° AIMING ANGLE Illumination on horizontal Plane 	D	FC	L	W	D	FC	L	W	D	FC	L	W	D	FC	L	W	D	FC	L	W
	6'	153	0.8'	0.7'	5'	122	1.6'	1.4'	5'	135	1.4'	1.2'	8'	193	1.3'	1.1'	7'	159	2.0'	1.7'
	9'	68	1.3'	1.1'	7'	62	2.3'	2.0'	7'	69	2.0'	1.7'	12'	86	2.0'	1.7'	10'	78	2.8'	2.4'
	12'	38	1.7'	1.5'	9'	38	3.0'	2.6'	9'	42	2.5'	2.2'	16'	48	2.6'	2.3'	13'	46	3.7'	3.2'
30° AIMING ANGLE Illumination on vertical Plane 	D	FC	L	W	D	FC	L	W	D	FC	L	W	D	FC	L	W	D	FC	L	W
	2'	266	0.8'	0.4'	2'	147	2.1'	1.0'	2'	163	1.7'	0.8'	4'	148	2.0'	1.0'	3'	167	2.6'	1.3'
	3'	118	1.3'	0.6'	3'	65	3.1'	1.5'	3'	72	2.6'	1.3'	6'	66	3.0'	1.5'	4'	94	3.5'	1.7'
	4'	66	1.7'	0.8'	4'	37	4.1'	2.0'	4'	41	3.5'	1.7'	8'	37	4.0'	2.0'	5'	60	4.3'	2.1'

		Medium										
		45W PAR38 FL (T-H)	75W PAR38 FL	90W PAR38 FL (T-H)								
DISTANCE												
FOTCANDLES (On Beam Center At 6')		47	52	111								
BAM SPREAD (To 50% Max. CP)		28°	30°	30°								
MAX. CANDLEPOWER (Candelas)		1,700	1,860	4,000								
RATED LIFE (Hours)		2,000	2,000	2,000								
90° AIMING ANGLE Illumination on horizontal Plane 	D	FC	L	W	D	FC	L	W	D	FC	L	W
	3'	189	1.5'	1.5'	4'	116	2.1'	2.1'	6'	111	3.2'	3.2'
	5'	68	2.5'	2.5'	6'	52	3.2'	3.2'	8'	63	4.3'	4.3'
	7'	35	3.5'	3.5'	8'	29	4.3'	4.3'	10'	40	5.4'	5.4'
60° AIMING ANGLE Illumination on horizontal Plane 	D	FC	L	W	D	FC	L	W	D	FC	L	W
	3'	123	2.0'	1.7'	5'	134	2.2'	1.9'	5'	104	3.7'	3.1'
	5'	44	3.4'	2.9'	7'	48	3.7'	3.1'	7'	53	5.1'	4.3'
	7'	23	4.8'	4.0'	9'	25	5.1'	4.3'	9'	32	6.6'	5.6'
30° AIMING ANGLE Illumination on vertical Plane 	D	FC	L	W	D	FC	L	W	D	FC	L	W
	1'	213	2.5'	1.0'	1'	233	2.7'	1.1'	2'	125	5.5'	2.1'
	2'	53	4.9'	2.0'	2'	58	5.5'	2.1'	3'	56	8.2'	3.2'
	3'	24	7.4'	3.0'	3'	28	8.2'	3.2'	4'	34	11.9'	4.3'

Job Information **Type:**

Lightolier a Genlyte Thomas Company www.lightolier.com
 631 Airport Road, Fall River, MA 02720 • (508) 679-8131 • Fax (508) 674-4710
 We reserve the right to change details of design, materials and finish.
 © 2011 Genlyte Thomas Group LLC (Lightolier Division) • B0711

LIGHTOLIER®