

C6L1520DL (W)

Calculite LED 6" Downlight Wide Beam

Page 1 of 3

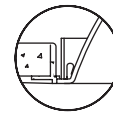
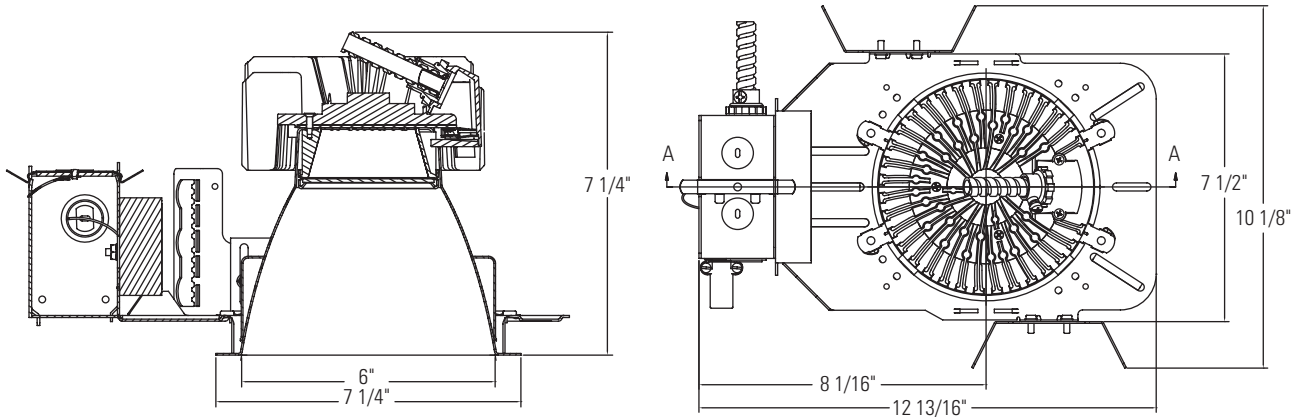

Flangeless Trim with
Plaster Ring Accessory CA6FMR
(Recommended for gypsum installations)

Ordering Guide: Light Engines

Light Engine Series	Style	Color Temperature	Beam Spread	Reflector Finish	Flange	Options
C6L1520	DL (Downlight)	27K (2700K) 30K (3000K) 35K (3500K) 40K (4000K)	W (Wide beam, 1.2 s.c.)	CL (Clear) CCL (Comfort Clear) CCD (Comfort Clear Diffuse) CCZ (Champagne Bronze) WH (Painted White)	W (Painted white) P (Aperture-matching/polished) FT (Flush-mount/flangeless) ¹	EM (Integral emergency test switch)

Example:
C6L1520DL35KWCCLEWEM

¹Accessory CA6FMR recommended for gypsum applications. Reflector flange is 1/8".

Ordering Guide: Frame-in Kits

Frame-in Kit Series	Installation Options	Input Voltage	Options
C6L15 (1500 Lumen) C6L20 (2000 Lumen)	N (New construction) R (Remodeler)	1 (120V) 2 (277V)	Blank (0-10 volt dimming) EM (Emergency)
CUL15 (1500 Lumen) CUL20 (2000 Lumen)	J (J-box mount retrofit) S (Screw-in base retrofit (120V only))	1 (120V) 2 (277V)	Blank (0-10 volt dimming)

Example: C6L15NIEM

Job Information	Type:
Job Name:	
Cat. No.:	
Notes:	

PHILIPS
LIGHTOLIER

C6L1520DL (W)

Calculite LED 6" Downlight Wide Beam

Page 2 of 3

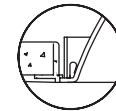
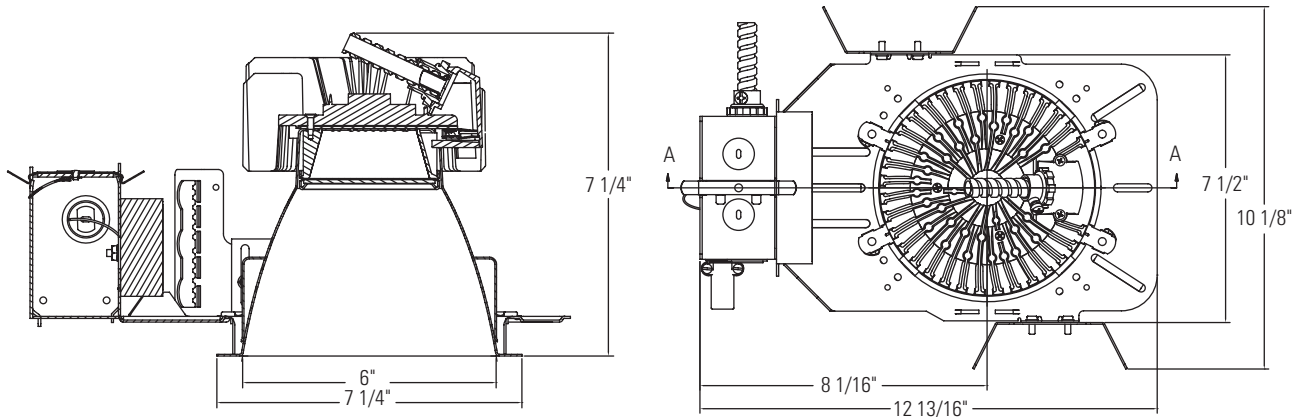

Flangeless Trim with
Plaster Ring Accessory CA6FMR
(Recommended for gypsum installations)

Features

Aperture: 6" (152 mm) I.D., 7 1/4" (184mm) O.D.

Input Wattage: 27W (1500 Lumens), 39W (2000 Lumens).

Reflector Cone: Aluminum. Provides 50° cutoff to source & source image. Self-flanged.

Depth (including Frame-in kit): 7 1/4" (184mm)

Power Connection: Attaches to frame-in kit via push-in connector (on frame). Removable cover provides access.

Technology

LED Board: Array of high brightness royal blue LED's.

Remote Phosphor Technology: Remote phosphor technology provides increased efficiency and color consistency. Phosphor lens assembly positioned in front of LED array converts blue light to white. Color shift will not exceed +/- 100K over life.

Optical Mixing Chamber: Lightolier-specific mixing chamber redirects back-reflected light through aperture resulting in 20% increase in efficiency.

Thermal Management: Heat sink and thermal design along with clean room assembly ensures specified performance.

Technology (continued)

Rated Life: Based on IESNA LM-80-2008

1500 Lumen – 60,000 hours at 70% lumen maintenance.

2000 Lumen – 57,000 hours at 70% lumen maintenance.

Photometric Performance: Tested in accordance to IESNA LM-79-2008

Options

Dimming Capability: 0-10V. See LED-DIM specification sheet

Emergency Capability (Integral): Add "EM" suffix. See LED-EM spec sheet.

Emergency Capability (Inverter): See LED-LMI specification sheet.

Labels

UL (suitable for wet locations), cUL, I.B.E.W.
5 Year Warranty

Job Information	Type:
------------------------	--------------

PHILIPS

LIGHTOLIER

C6L1520DL (W)

Calculite LED 6" Downlight Wide Beam

Correlated Color Temperature (CCT) Multipliers: 2700K (x 0.92), 3000K (x 1.00), 3500K (x 1.07), 4000K (x 1.14)

Reflector Finish Multipliers: CL (x 1.00), CCL (x 0.92), CCD (x 0.90), CCZ (x 0.73), WH (x 0.80) — CL & CCD finishes are tested. CCL, CCZ & WH are calculated.

1500 LM, 3000K, CL FINISH TRIM

Candlepower Distribution

ANGLE	MEAN CP	LUMENS
0	1000	
5	1001	96
10	1010	
15	1056	297
20	1049	
25	1003	459
30	911	
35	742	451
40	475	
45	108	116
50	10	
55	5	5
60	3	
65	2	2
70	1	
75	1	1
80	0	
85	0	0
90	0	

Trim/Frame:
C6L1520DL30KWCLW/C6L15N1

Output lumens: 1426 lm
Correlated Color Temp¹: 3000K
Input Watts²: 26.9 w
Efficacy: 53.0 lm/w
CRI³: 78
Spacing Criterion: 1.2

CEILING WALL	80%				70%				50%				30%				0%
	70	50	30	10	50	10	50	10	50	10	50	10	50	10	50	10	0
RCR	Zonal Cavity Method - Effective Floor Cavity Reflectance = 20%																
0	119	119	119	119	116	116	111	111	111	111	106	106	106	100	106	106	100
1	113	110	108	105	108	104	104	100	100	100	97	93	88	82	79	88	82
2	107	102	98	94	100	93	97	91	94	89	86	86	82	79	86	82	79
3	101	94	89	85	93	84	90	83	88	82	79	72	79	72	79	72	72
4	96	87	82	77	86	77	84	76	82	75	72	67	72	67	72	67	67
5	90	81	75	70	80	70	78	69	77	69	67	63	67	63	67	63	61
6	85	75	69	64	75	64	73	64	72	63	61	57	67	57	67	57	57
7	80	70	64	59	70	59	68	59	67	57	57	52	63	52	63	52	52
8	76	66	59	55	65	55	64	54	63	54	52	49	59	50	59	50	49
9	72	61	55	51	61	51	60	50	59	50	49	45	57	47	57	47	45
10	68	57	51	47	57	47	56	47	55	47	45	45	55	47	55	47	45

ZONAL LUMENS AND PERCENTAGES

ZONE	LUMENS	%LUMINAIRE
0-30	851	59.7%
0-40	1303	91.4%
0-60	1424	99.8%
0-90	1426	100.0%

Single Unit Data

Height to Lighted Plane	Initial Footcandles	Beam Diameter
5'	40	8'
6'	28	10'
7'	20	12'
8'	16	13'
9'	12	15'

Multiple Unit Data - RCR 2

Spacing On Ctr.	Initial Footcandles	Watts/ Sq. Ft.
5'	64.4	1.19
6'	42.2	0.78
7'	30.2	0.56
8'	25.1	0.47
9'	20.1	0.37

38'x38'x10' Room, Workplane 2 1/2' above floor, 80/50/20% Reflectances

CERTIFIED TEST REPORT NO. 18205⁴

2000 LM, 3000K, CL FINISH TRIM

Candlepower Distribution

ANGLE	MEAN CP	LUMENS
0	1369	
5	1371	131
10	1382	
15	1445	407
20	1436	
25	1374	629
30	1249	
35	1017	619
40	653	
45	149	160
50	14	
55	7	6
60	4	
65	2	2
70	1	
75	1	1
80	0	
85	0	0
90	0	

Trim/Frame:
C6L1520DL30KWCLW/C6L20N1

Output lumens: 1954 lm
Correlated Color Temp¹: 3000K
Input Watts²: 39.8 w
Efficacy: 49.1 lm/w
CRI³: 78
Spacing Criterion: 1.2

CEILING WALL	80%				70%				50%				30%				0%
	70	50	30	10	50	10	50	10	50	10	50	10	50	10	50	10	0
RCR	Zonal Cavity Method - Effective Floor Cavity Reflectance = 20%																
0	119	119	119	119	116	116	111	111	111	106	106	106	100	106	106	100	100
1	113	110	108	105	108	104	104	100	100	100	97	93	88	82	79	88	82
2	107	102	98	94	100	93	97	91	94	89	86	86	82	79	86	82	79
3	101	94	89	85	93	84	90	83	88	82	79	72	79	72	79	72	72
4	96	87	82	77	86	77	84	76	82	75	72	67	72	67	72	67	67
5	90	81	75	70	80	70	78	69	77	69	67	63	67	63	67	63	61
6	85	75	69	64	75	64	73	64	72	63	61	57	67	57	67	57	57
7	80	70	64	59	70	59	68	59	67	57	57	52	63	52	63	52	52
8	76	66	59	55	65	55	64	54	63	54	52	49	59	50	59	50	49
9	72	61	55	51	61	51	60	50	59	50	49	45	57	47	57	47	45
10	68	57	51	47	57	47	56	47	55	47	45	45	55	47	55	47	45

ZONAL LUMENS AND PERCENTAGES

ZONE	LUMENS	%LUMINAIRE
0-30	1166	59.7%
0-40	1785	91.3%
0-60	1951	99.8%
0-90	1954	100.0%

Single Unit Data

Height to Lighted Plane	Initial Footcandles	Beam Diameter
5'	55	8'
6'	38	10'
7'	28	12'
8'	21	13'
9'	17	15'

Multiple Unit Data - RCR 2

Spacing On Ctr.	Initial Footcandles	Watts/ Sq. Ft.
5'	88.2	1.76
6'	57.9	1.16
7'	41.3	0.83
8'	34.5	0.69
9'	27.6	0.55

38'x38'x10' Room, Workplane 2 1/2' above floor, 80/50/20% Reflectances

CERTIFIED TEST REPORT NO. 18206⁴

¹ Correlated Color Temperature within specs as defined in ANSI_NEMA_ANSI C78.377-2008: Specifications for the Chromaticity of Solid-State Lighting Products.

² Wattage controlled to within 5%.

³ Tested using absolute photometry as specified in LM79: IESNA Approved Method for the Electrical and Photometric Measurements of Solid-State Lighting Products.

⁴ Color Rendering Index within +/- 2%.



Philips Lightolier
e: lol.webmaster@philips.com
t: (508) 679-8131
w: www.lightolier.com

C6L1520DL(W) October 18, 2011

Specifications are subject to change without notice.
© Koninklijke Philips Electronics N.V., 2011. All rights reserved.

Job Information Type: