

# Calculite® HID Adjustable Accent **C4T4GA-MHT4RF**

Page 1 of 4

4 1/2" Aperture, T4 Ceramic Metal Halide Glasslite, Flood

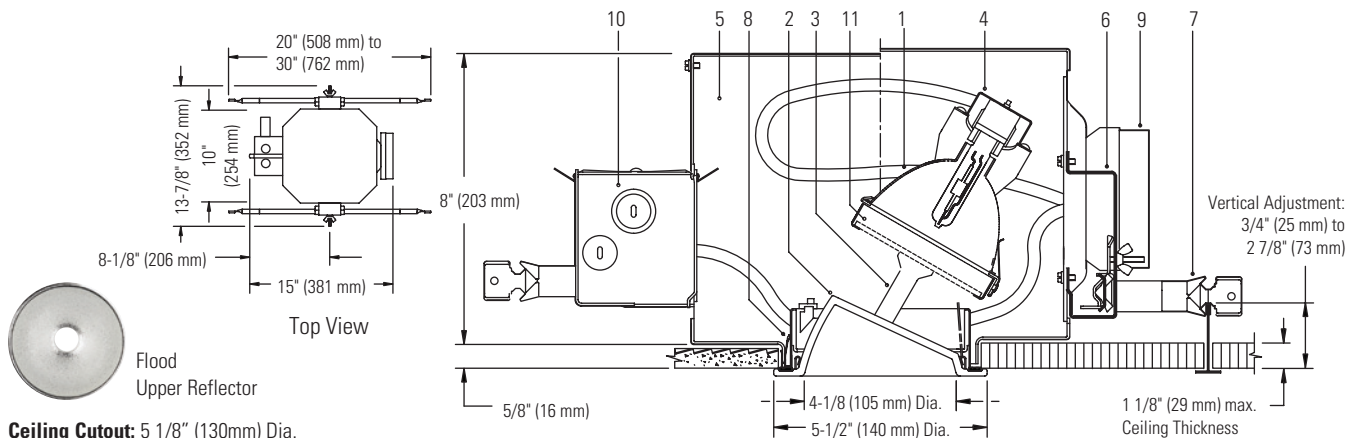

For Complete Fixture Order: Glasslite Trim Kit + Flood Upper Reflector (MHT4RF) + Frame-In Kit. Each Sold Separately.

Glasslite Trim Kit + Flood Upper Reflector	Frame-In Kit	Lamping (Ceramic Metal Halide)
<b>C4T4GA + MHT4RF (Flood Upper Reflector)</b> Etched glass, with matching flange.	<b>C4A20BT5PGJ5E1</b> Electronic 120V	22W Philips MiniMasterColor
	<b>C4A20T4GU65EU</b> Electronic 120V/277V	20W GE ConstantColor
	<b>C4A20T4EU</b> Electronic 120V/277V	20W T4.5
	<b>C4A39T4GU65EU</b> Electronic 120V/277V	39W Philips MiniMasterColor
	<b>C4A39T4E1</b> Electronic 120V	39W T4.5
	<b>C4A39T4E2</b> Electronic 277V	39W T4.5
	<b>C4A70T4E1</b> Electronic 120V	70W T4.5
	<b>C4A70T4E2</b> Electronic 277V	70W T4.5

## Features

- Flood Upper Reflector:** Specular textured aluminum; provides 40° beam. Interchangeable with 12° Spot (MHT4RS) and 25° Narrow Flood (MHT4RNF); see spec sheets C4T4GA-MHT4RS and C4T4GA-MHT4RNF.
- Trim Kit:** One piece borosilicate etched glass.
- Trim Kit Adjustment Mechanism:** Provides 35° vertical tilt, 360° horizontal rotation; lockable. EZ-Aim™ Helical Drive System provides fast and accurate hot aiming with Philips screwdriver.
- Socket Housing:** Galvanized steel, pre-wired with G8.5 pulse rated socket. Snaps onto yoke for secure attachment without tools; unitized construction assures proper alignment of lamp to optics for consistent optical performance.
- Frame Housing:** Steel, 0.029" (22-Ga.), matte black finish. Removable cover for top re-lamping.
- Frame Vertical Adjustment Mechanism:** Accommodates mounting to virtually any ceiling system using pre-installed mounting bars, or 1/2" EMT tubing (by others). Single locking feature secures all adjustments. Alignment holes and markings allow fixture to be pre-set prior to installation. Final adjustment can be made from below from inside fixture.
- Mounting Bars:** Galvanized steel, 0.048" (18-ga.), pre-installed telescoping bars extend to 30" long and lock securely into position. Built-in locking tabs provide positive attachment to common T-bar systems. Self-centering feature simplifies installation in 24" O.C. grid systems. Attaches to steel or wood joists without accessories.
- Retention Springs:** Rust resistant springs secure trim for quick, tool-less installation.
- Ballast / Cover Assembly:** Accessible from below and removable without tools for inspection and ballast replacement.
- Junction Box:** 0.059" (16-ga.) galvanized steel. UL listed for 8 No. 12 AWG, 90° C through branch circuit conductors. Allows inspection from below.
- Accessory Holder:** Sold separately catalog # CAH4; die-formed steel, matte black finish, slide-in installation. Accepts up to two 3 3/4" dia. media.

## Electrical

**Electronic Ballast:** 120V or 277V, 50/60 Hz., encased, high power factor, T.H.D. <15%, thermally and transient protected, RMI/RFI complies with FCC Part 18 non-consumer limits, shut-down circuit at end of lamp life, sound rating "A", -5°F minimum starting temperature, Type 1 Outdoor rating.

Ballast	ANSI Code	Voltage	Max. Amps	Input Watts
20W MH	M156	120/277	0.21/0.10	23
39W MH	M130	120/277	0.39/0.17	44
70W MH	M139	120/277	0.67/0.29	78

## Options and Accessories

Chicago Plenum: Consult Factory

## Labels

UL (Suitable for Wet Locations), CSA, I.B.E.W.

## Job Information

Type:

Job Name:

Cat. No.:

Lamp(s):

Notes:

# Calculite® HID Adjustable Accent **C4T4GA-MHT4RF**

(FC) is initial footcandles at center of beam. Beam length (L) and beam width (W) are to where the candlepower is reduced to 50% of the center beam candlepower. (C) is the distance to the center of the beam.

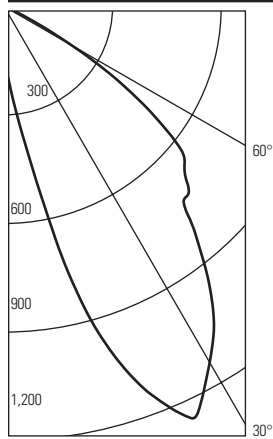
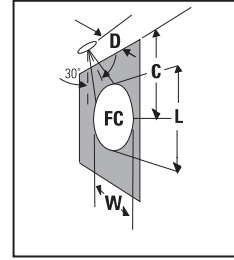
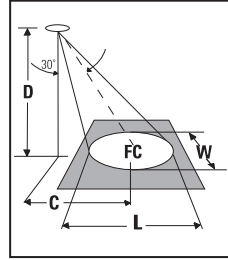

ANGLE	WALL
0	143
5	242
10	456
15	865
20	1120
25	1251
30	1136
35	1003
40	823
45	722
50	650
55	465
60	218
65	46
70	12
75	10
80	8
85	5
90	0

AIMED 30 deg. TOWARD WALL  
LAMP: 20W CERAMIC MH, GE  
LUMEN RATING: 1700 LMS.  
CBCP: 1251  
Beam Angle: 39  
AROMAT 20W ELECTRONIC BALLAST  
DATE: APR 15, 2004  
CERTIFIED TEST REPORT NO. 18686

Candlepower Distribution 20W T4.5 - Flood Reflector

30° Aiming Angle Horizontal Surface					30° Aiming Angle Vertical Surface				
D	C	FC	L	W	D	C	FC	L	W
6'	3.5'	23	5.9'	4.9'	2'	3.5'	39	9.1'	2.8'
8'	4.6'	13	7.9'	6.5'	3'	5.2'	17	13.6'	4.2'
10'	5.8'	8	9.9'	8.2'	4'	6.9'	10	18.2'	5.7'
12'	6.9'	6	11.8'	9.8'	6'	10.4'	4	27.2'	8.5'
15'	8.7'	4	14.8'	12.3'	8'	13.9'	2	36.3'	11.3'

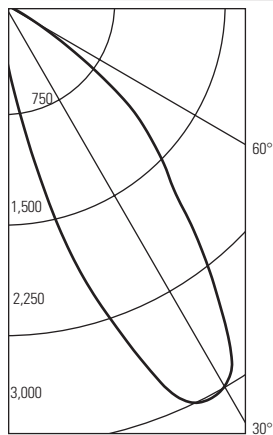

ANGLE	WALL
0	274
5	488
10	951
15	1753
20	2432
25	2979
30	2993
35	2595
40	1999
45	1534
50	1173
55	649
60	245
65	64
70	26
75	19
80	6
85	0
90	0

AIMED 30 deg. TOWARD WALL  
LAMP: 39W CERAMIC MH, PHILIPS  
LUMEN RATING: 3400 LMS.  
CBCP: 2993  
Beam Angle: 32  
AROMAT 39W ELECTRONIC BALLAST  
DATE: APR 13, 2004  
CERTIFIED TEST REPORT NO. 18687

Candlepower Distribution 39W T4.5 - Flood Reflector

30° Aiming Angle Horizontal Surface					30° Aiming Angle Vertical Surface				
D	C	FC	L	W	D	C	FC	L	W
8'	4.6'	30	6.3'	5.3'	3'	5.2'	42	9.1'	3.4'
10'	5.8'	19	7.9'	6.6'	4'	6.9'	23	12.2'	4.6'
12'	6.9'	14	9.4'	7.9'	6'	10.4'	10	18.3'	6.9'
15'	8.7'	9	11.8'	9.9'	8'	13.9'	6	24.4'	9.2'
20'	11.5'	5	15.7'	13.2'	12'	20.8'	3	36.5'	13.8'

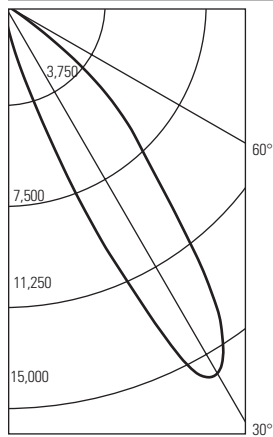

ANGLE	WALL
0	141
5	288
10	909
15	2640
20	6497
25	12581
30	15817
35	13798
40	9527
45	6823
50	4410
55	1573
60	338
65	45
70	29
75	18
80	11
85	0
90	0

AIMED 30 deg. TOWARD WALL  
LAMP: 70W CERAMIC MH, PHILIPS  
LUMEN RATING: 6200 LMS.  
CBCP: 15817  
Beam Angle: 22  
AROMAT 70W ELECTRONIC BALLAST  
DATE: APR 14, 2004  
CERTIFIED TEST REPORT NO. 18688

Candlepower Distribution 70W T4.5 - Flood Reflector

30° Aiming Angle Horizontal Surface					30° Aiming Angle Vertical Surface				
D	C	FC	L	W	D	C	FC	L	W
8'	4.6'	161	4.2'	3.6'	3'	5.2'	220	5.3'	2.3'
10'	5.8'	103	5.2'	4.5'	4'	6.9'	124	7.0'	3.1'
12'	6.9'	71	6.3'	5.4'	6'	10.4'	55	10.5'	4.7'
15'	8.7'	46	7.9'	6.7'	8'	13.9'	31	14.0'	6.2'
20'	11.5'	26	10.5'	9.0'	12'	20.8'	14	21.0'	9.3'

**Job Information** **Type:**

# Calculite® HID Adjustable Accent **C4T4GA-MHT4RF**

**22W PGJ5** Philips MiniMastercolor CMH Lamp, **Flood** Upper Reflector, Lumen Rating = 1650 lms, Aromat Electronic Ballast

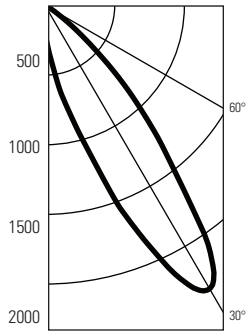

Angle	Wall
0	198
5	341
10	620
15	952
20	1510
25	2057
30	2352
35	1975
40	1296
45	797
50	382
55	144
60	42
65	14
70	12
75	9
80	7
85	4
90	3

30° Aiming Angle Horizontal Surface					30° Aiming Angle Vertical Surface				
D	C	FC	L	W	D	C	FC	L	W
6'	3.5'	42	3.5'	2.9'	2'	3.5'	74	3.9'	1.7'
8'	4.6'	24	4.6'	3.9'	3'	5.2'	33	5.9'	2.6'
10'	5.8'	15	5.8'	4.9'	4'	6.9'	18	7.9'	3.4'
12'	6.9'	11	6.9'	5.9'	6'	10.4'	8	11.8'	5.1'
15'	8.7'	7	8.6'	7.4'	8'	13.9'	5	15.7'	6.8'

Certified Test Report No. 3936FR, Date: Oct 16, 2008. Computed by LSI Program \*\*Test-Lite\*\*

**39W PGJ5** Philips MiniMastercolor CMH Lamp, **Flood** Upper Reflector, Lumen Rating = 3000 lms, Aromat Electronic Ballast

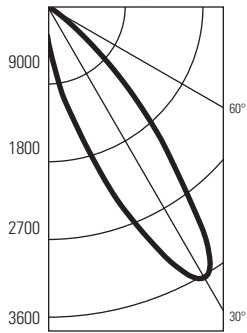

Angle	Wall
0	342
5	596
10	1071
15	1605
20	2410
25	3174
30	3628
35	3101
40	2105
45	1264
50	584
55	210
60	59
65	20
70	16
75	14
80	9
85	5
90	0

30° Aiming Angle Horizontal Surface					30° Aiming Angle Vertical Surface				
D	C	FC	L	W	D	C	FC	L	W
6'	3.5'	65	3.6'	3.1'	2'	3.5'	113	4.2'	1.8'
8'	4.6'	37	4.8'	4.1'	3'	5.2'	50	6.2'	2.7'
10'	5.8'	24	6.0'	5.1'	4'	6.9'	28	8.3'	3.5'
12'	6.9'	16	7.2'	6.1'	6'	10.4'	13	12.5'	5.3'
15'	8.7'	10	9.0'	7.7'	8'	13.9'	7	16.6'	7.1'

Certified Test Report No. 3936FR, Date: Oct 16, 2008. Computed by LSI Program \*\*Test-Lite\*\*

**Job Information** **Type:**

# Calculite® HID Adjustable Accent **C4T4GA-MHT4RF**

**20W GU6.5** GE Constantcolor CMH Lamp, **Flood** Upper Reflector, Lumen Rating = 1615 lms, Aromat Electronic Ballast

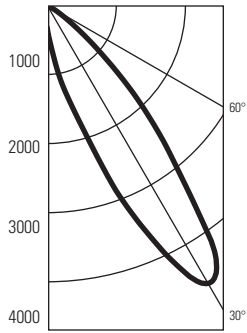

Angle	Wall
0	143
5	255
10	464
15	716
20	1129
25	1645
30	2006
35	1877
40	1261
45	802
50	396
55	167
60	53
65	14
70	11
75	8
80	7
85	5
90	2

30° Aiming Angle Horizontal Surface					30° Aiming Angle Vertical Surface				
D	C	FC	L	W	D	C	FC	L	W
6'	3.5'	36	3.5'	2.9'	2'	3.5'	63	3.9'	1.7'
8'	4.6'	20	4.6'	3.9'	3'	5.2'	28	5.9'	2.6'
10'	5.8'	13	5.8'	4.9'	4'	6.9'	16	7.9'	3.4'
12'	6.9'	9	6.9'	5.9'	6'	10.4'	7	11.8'	5.1'
15'	8.7'	6	8.6'	7.4'	8'	13.9'	4	15.7'	6.8'

Certified Test Report No. 3929FR, Date: Oct 16, 2008. Computed by LSI Program \*\*Test-Lite\*\*

**39W GU6.5** GE Constantcolor CMH Lamp, **Flood** Upper Reflector, Lumen Rating = 3400 lms, Aromat Electronic Ballast

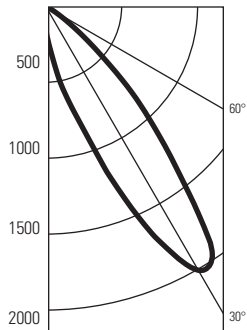

Angle	Wall
0	321
5	568
10	1074
15	1668
20	2758
25	3883
30	4646
35	4096
40	2705
45	1663
50	815
55	334
60	100
65	27
70	21
75	16
80	11
85	7
90	2

30° Aiming Angle Horizontal Surface					30° Aiming Angle Vertical Surface				
D	C	FC	L	W	D	C	FC	L	W
6'	3.5'	84	3.5'	2.9'	2'	3.5'	145	3.9'	1.7'
8'	4.6'	47	4.6'	3.9'	3'	5.2'	65	5.9'	2.6'
10'	5.8'	30	5.8'	4.9'	4'	6.9'	36	7.9'	3.4'
12'	6.9'	21	6.9'	5.9'	6'	10.4'	16	11.8'	5.1'
15'	8.7'	13	8.6'	7.4'	8'	13.9'	9	15.7'	6.8'

Certified Test Report No. 3931FR, Date: Oct 16, 2008. Computed by LSI Program \*\*Test-Lite\*\*

**Job Information** **Type:**